

Curtsinger's Traffic Procedures



In order to ensure the safety of all Curtsinger students, the Frisco Police Department and Frisco ISD's Director of Security have created the following procedures that will be implemented by all faculty, parents, and students of Curtsinger Elementary. We are asking for your cooperation and patience with our morning and afternoon dismissal procedures. Please know that your child's safety is our first priority.

Morning Drop-Off Procedures

For the safety of our students:

- Students must be dropped off in the front of the school or in the circle drive off Norfolk.
- Students must enter the building through the front doors.
- During drop-off, parents **must turn LEFT** into the school's front parking lot or circle drive, and **must turn RIGHT** when exiting.

DO NOT DROP OFF YOUR CHILD(REN) BY THE:

- Teacher's Parking Lot
- Cafeteria Doors
- Portables
- Basketball Court



Curtsinger's Before School Waiting Areas



School Hours

School Begins: 8:00 am

Students are tardy after: 8:00 am

Morning Dismissal to Classroom: 7:55 am

(for those who arrive between 7:30–7:55 am)

Kindergarteners:

- Go to the back of POD 1
- Find teacher's name (with assistance)
- Sit in a line behind teacher's name until the morning dismissal bell

First & Second Graders:

- Go to the gym
- Find teacher's name (located on floor)
- Sit in a line behind teacher's name until the morning dismissal bell

Third Graders:

- Go to the cafeteria
- Find teacher's name (located on floor)
- Sit in a line behind teacher's name until the morning dismissal bell

Fourth & Fifth Graders:

- Go to the cafeteria
- Find teacher's name (located on floor)
- Sit in a line behind teacher's name until the morning dismissal bell rings



Curtsinger's Afternoon Pick-up Procedures

KINDERGARTEN & 1ST GRADE

Take Plantation to Jereme Trail to enter the school parking lot.

When entering the parking lot, please pull all the way forward to the flagpole to pick-up your child(ren).

DO NOT enter from Coit Road, as this is used for 3rd & 5th grade pick-up and will cause delays in the flow of traffic.

After picking up your child(ren), **you must turn right when exiting.**

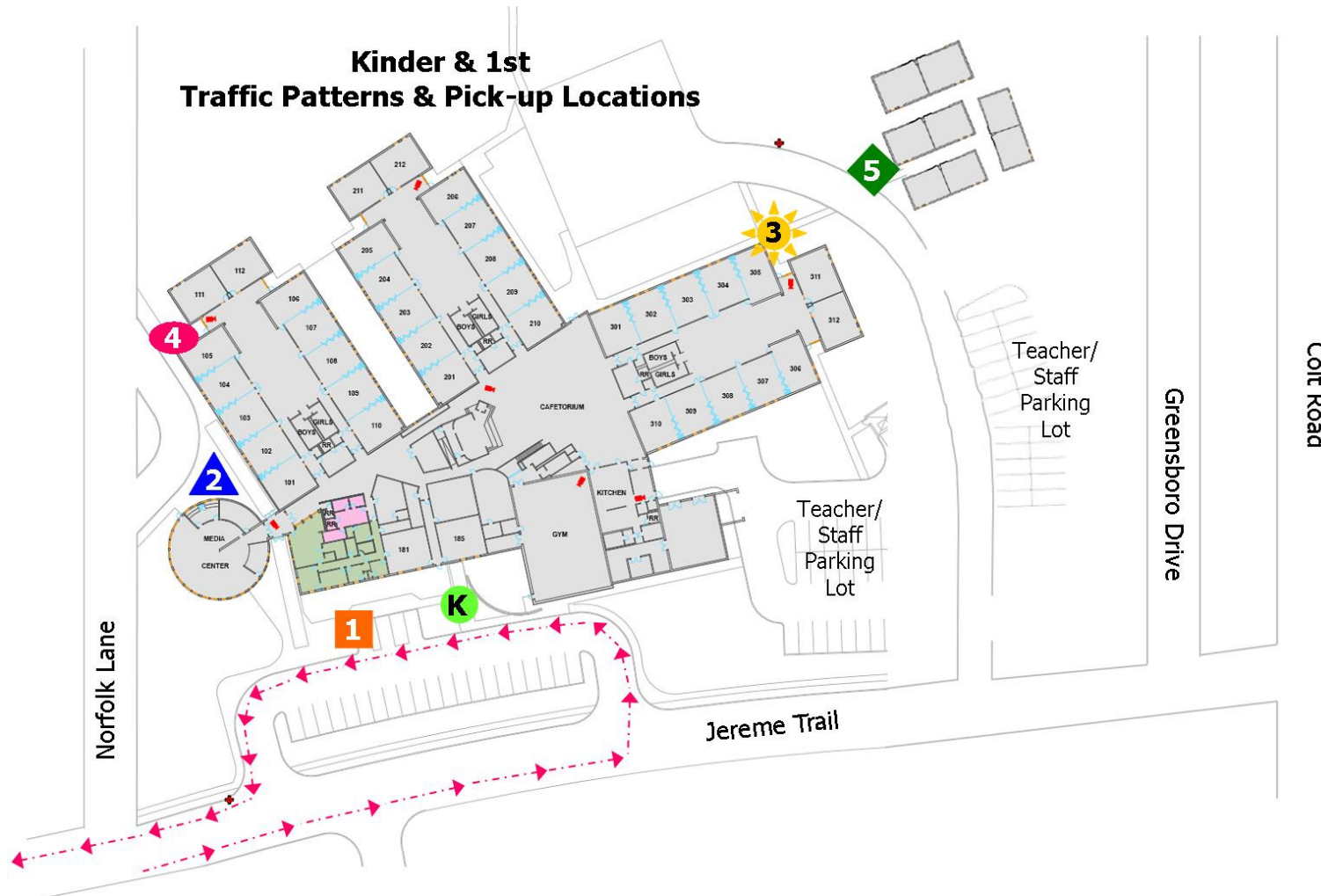

Curtsinger's Afternoon Pick-up Procedures

2ND & 4TH GRADE

- Take **Alexandria** (the road behind the school, nearest park/playground) and **turn left onto Norfolk Lane** (South) to enter the circle drive.
- When entering the circle drive, please **pull all the way forward** to the end of the building to pick-up your child(ren).
- **DO NOT** enter from Jereme Trail, as it is used for Kinder & 1st grade pickup and will cause delays in the flow of traffic.
- After picking up your child(ren), **you must turn right when exiting.**

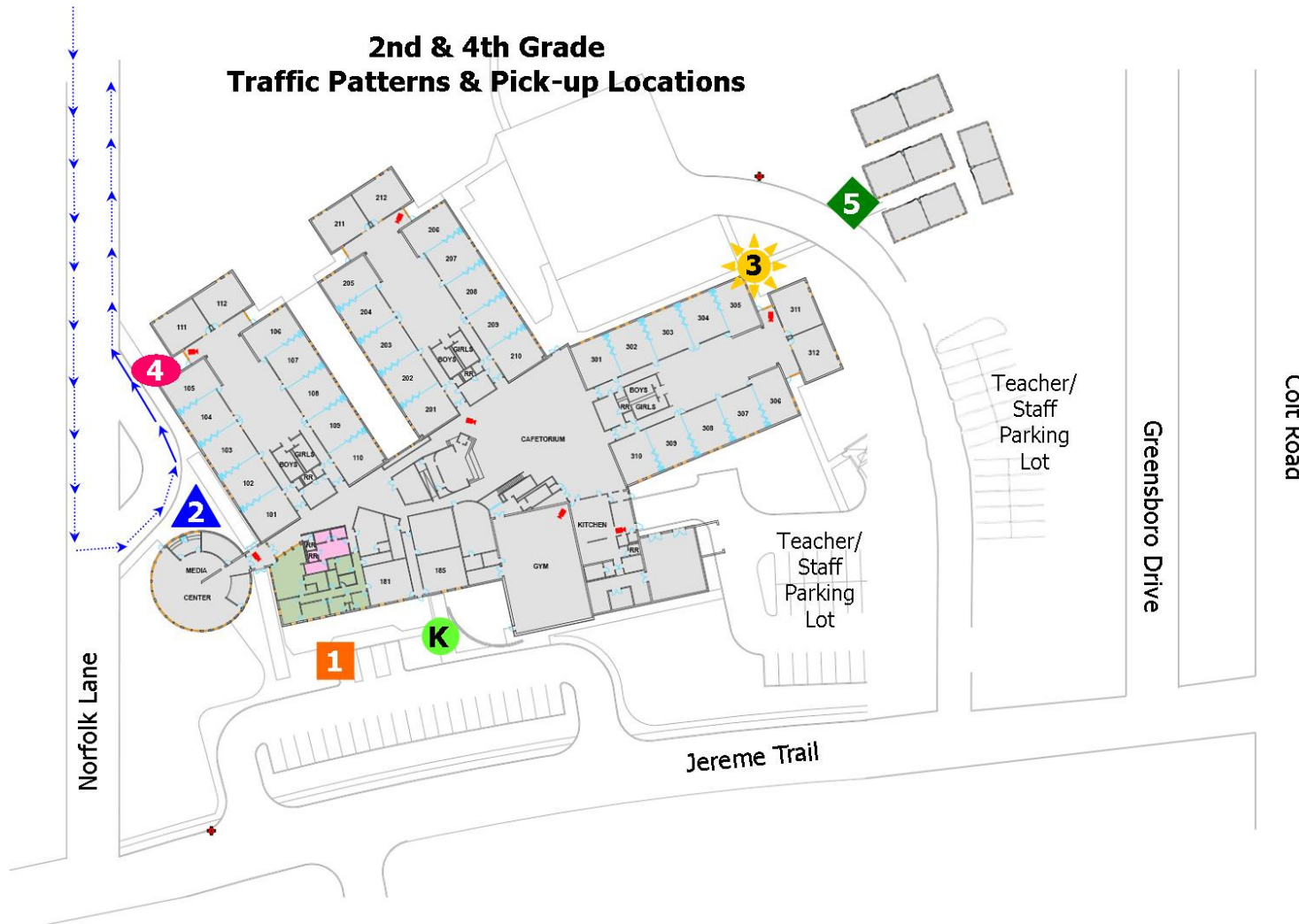

Curtsinger's Afternoon Pick-up Procedures

3RD & 5TH GRADE

- Take **Coit Road to Jereme Trail** to enter the teacher's parking lot.
- When entering the teacher's parking lot, please follow the road past the portables, circle around the basketball courts, and stop at the top of the gate to pick-up your children.
- Once you have picked up your child(ren), **you must turn left when exiting.**
- **DO NOT** exit to the right, as this will cause delays in the flow of traffic.

3rd & 5th Grade Traffic Patterns & Pick-up Locations

