

Curtsinger's Traffic Procedures

In order to ensure the safety of all Curtsinger students, the Frisco Police Department and Frisco ISD's Director of Security have created the following procedures that will be implemented by all faculty, parents, and students of Curtsinger Elementary. We are asking for your cooperation and patience with our morning and afternoon dismissal procedures. Please know that your child's safety is our first priority.



Morning Drop-Off Procedures

For the safety of our students:

- Students must be dropped off in the front of the school or in the circle drive.
- Students must enter the building through the front doors.
- During morning drop-off, parents **must turn left** into the school's front parking lot or circle drive, and **must turn right** when exiting these two areas.

DO NOT DROP OFF YOUR CHILD(REN) BY THE:

- Teacher's Parking Lot
- Cafeteria Doors
- Portables
- Basketball Court

Curtsinger's Before School Waiting Areas

School Hours

School Begins: 8:00 am

Students are tardy after: 8:00 am

Morning Dismissal to Classroom: 7:55 am
for those who arrive between 7:30 am – 7:55 am



Kindergarteners:

- Go to the back of POD 1
- Find teacher's name (with assistance)
- Sit behind teacher's name in a line until the school bell rings

First & Second Graders:

- Go to the gym
- Find teacher's name (located on floor)
- Sit behind teacher's name in a line until the school bell rings

Third Graders:

- Go to the cafeteria
- Find teacher's name (located on floor)
- Sit behind teacher's name in a line until the school bell rings

Fourth & Fifth Graders:

- Go to the cafeteria
- Find teacher's name on assigned table
- Sit down (no more than 8 to a table)
- Sit at the table with your teacher's name until the school bell rings

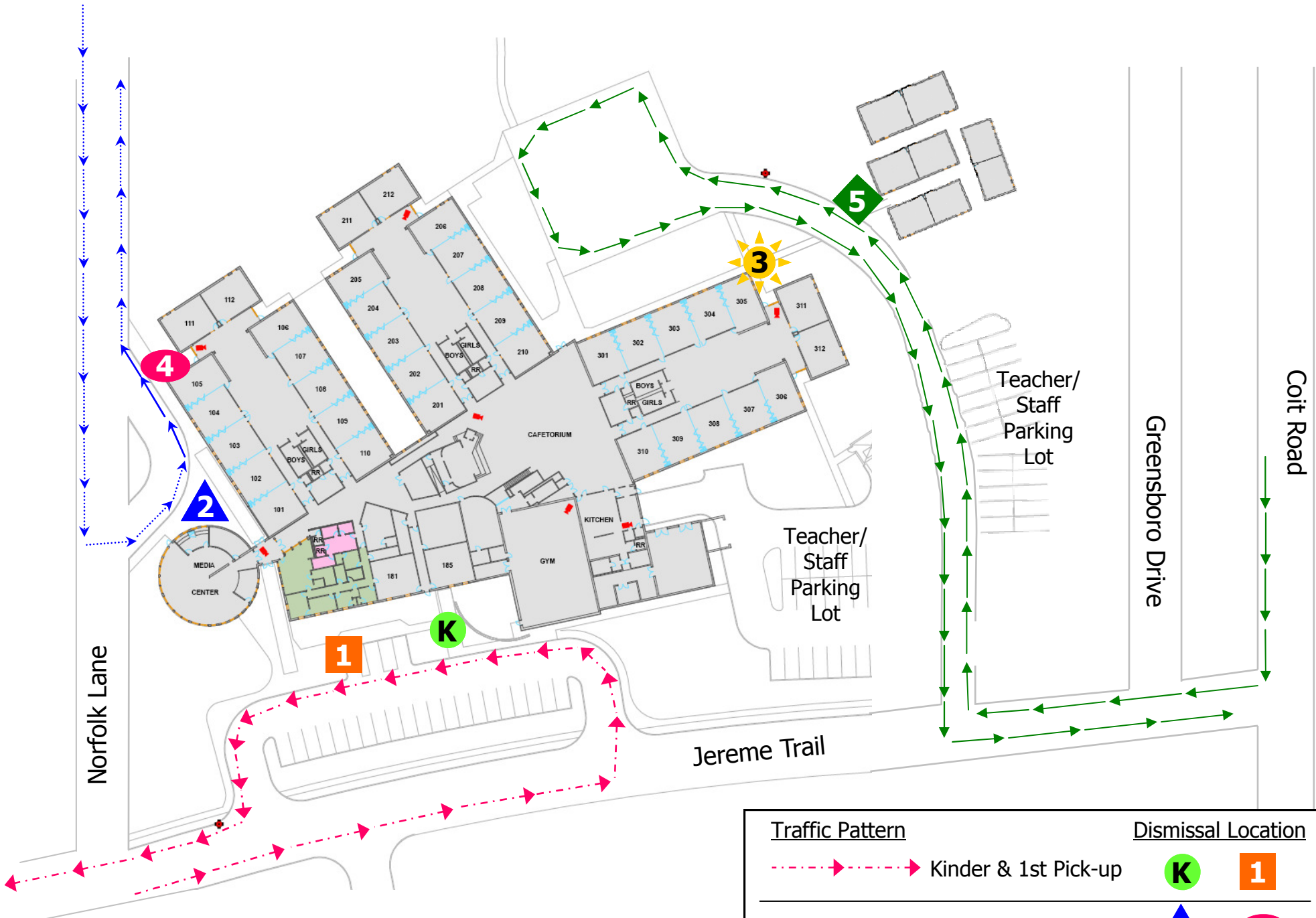

Curtsinger Elementary Traffic Patterns & Pick-up Locations

Traffic Pattern	Dismissal Location	
	Kinder & 1st Pick-up	
	2nd & 4th Pick-up	
	3rd & 5th Pick-up	

Curtsinger Elementary 2008-09

Afternoon Pick-Up Procedures

Please review the instructions and maps carefully.

KINGERGARTEN & 1ST GRADE

- **Take Plantation to Jereme Trail** to enter the school parking lot.
- When entering the parking lot, please pull all the way forward to the flagpole to pick-up your child(ren).
- **DO NOT** enter from Coit Road, as this is used for 3rd & 5th grade pick-up and will cause delays in the flow of traffic.
- After picking up your child(ren), **you must turn right when exiting.**

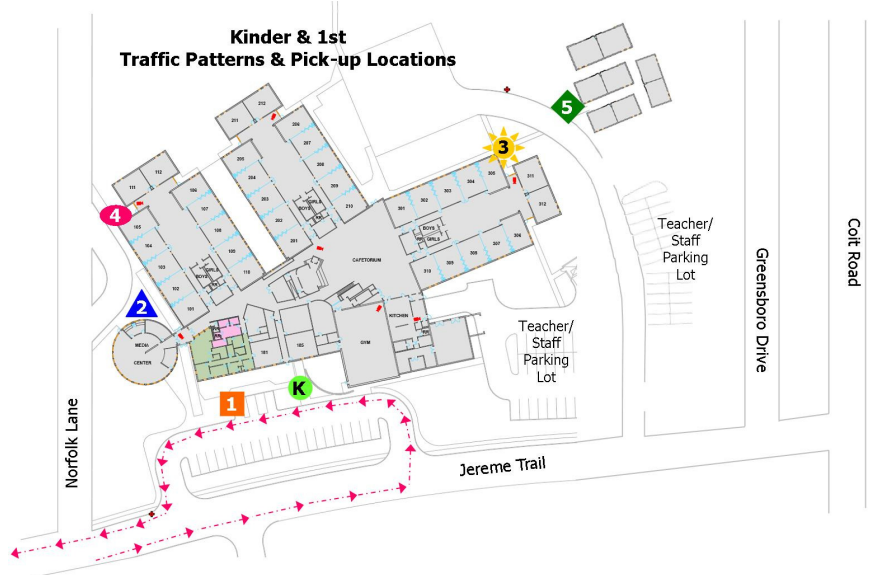

2ND & 4TH GRADE

- Take **Alexandria** (the road behind the school, nearest park/playground) and **turn left onto Norfolk Lane** (South) to enter the circle drive.
- When entering the circle drive, please pull all the way forward to the end of the building to pick-up your child(ren).
- **DO NOT** enter from Jereme Trail, as it is used for Kinder & 1st grade pickup and will cause delays in the flow of traffic.
- After picking up your child(ren), **you must turn right when exiting.**

